

PURIMU CONNECTION

The western end of CCD runs north, parallel to the Napier/Hastings Expressway before turning 90° towards the east coast.

Assessment of the drain identified the lack of water in this section despite the neighbouring property, Instant Green, irrigating adjacent to the water channel.

Installing a bore in this section of the drain would increase the volume of water, ensuring the channel has continuous water input, particularly in drier months. This would, in turn help increase ecological values and potential habitat along the drainage corridor.

In addition, installation of a weir would help to retain higher water levels within this section of CCD and other drier sections of the waterway.

Increased wetland and riparian planting would increase the health of the waterway and provide a visual buffer between the Expressway and drainage corridor. Specimen trees planted along the north side of the drain will increase amenity values and reflect existing trees to the east along the 'Pirimai bypass' section of the drain.

Introducing specimen trees where the shared path will be required to cross Ulyyatt Road, can be replicated at crossings where other roads intercept with the drainage corridor.

A newly developed shared path has been installed parallel to the Napier/Hastings Expressway, between CCD at Ulyyatt Road and the underpass that passes under the Expressway near Burness Road. This provides a connection between the suburbs on either side of the Expressway. Installing a crossing at the road and extending the path along the length of the drain will provide further connections to this.

LEGEND

- Existing trees
- Proposed trees
- Water channel
- Weir
- Artistic impression
- Grazing
- Wetland planting
- Riparian planting
- Shared path
- Fence
- Planting beyond boundary



LOCATION OF PLAN

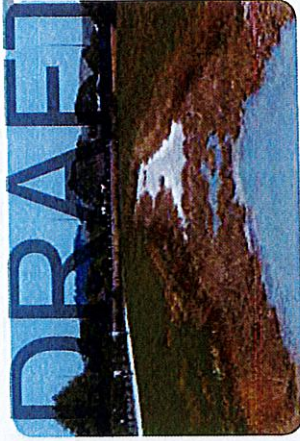

ARTISTIC IMPRESSION - SHORT TERM VISION

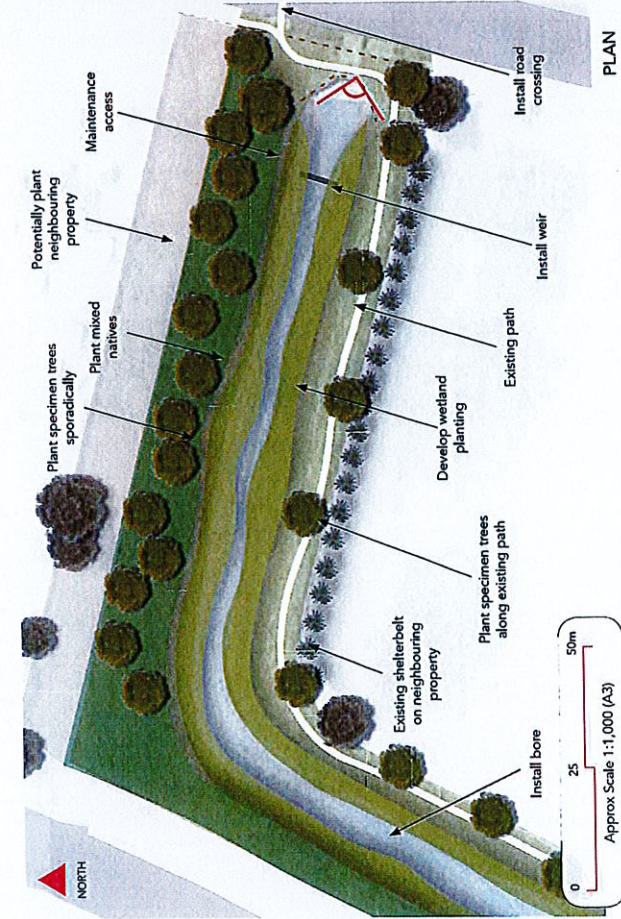
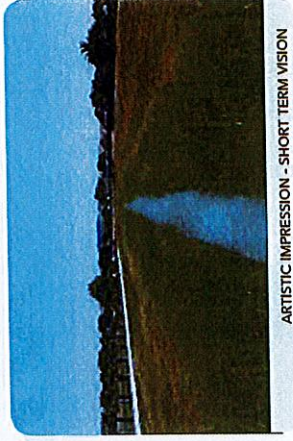

PLAN

Aerial photo 2014/15 sourced from linc.govt.nz

ARTISTIC IMPRESSION - LONG TERM VISION

